

TL-20 Draw Latch

Over-center · Wire bail

Features

- Compact latch
- Multiple link options for application variances

Material

- Stainless steel or steel, zinc plated

Notes

- Install assembly with M4 round head screws (not supplied) or 4 rivets
- Order keepers separately

Product Performance

- Steel working load:
 - Compact heavy-duty: 1,290 N
 - Compact: 220 N
- Stainless steel working load:
 - Compact heavy-duty: 800 N
 - Compact: 220 N



Exposed Mounting Holes

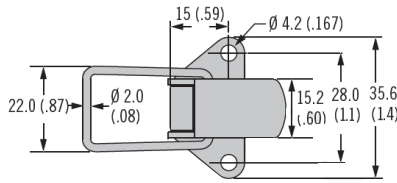

Concealed Mounting Holes

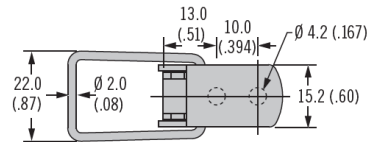

Heavy-Duty

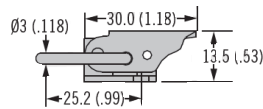

Flat Wire Link

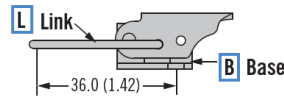

Flat Wire Link

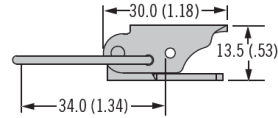

Short Curved Wire Link

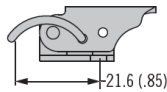

Short Curved Wire Link

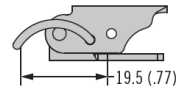

Long Curved Wire Link

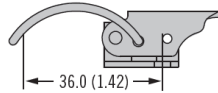

Long Curved Wire Link

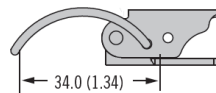

Shallow Hook Link

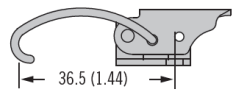

Shallow Hook Link

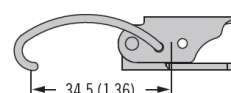

Deep Hook Link

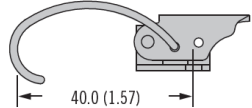

Deep Hook Link

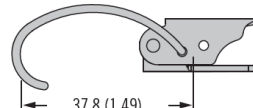

L Link style

- 1 Flat
- 2 Short curved
- 3 Long curved
- 4 Shallow hook
- 5 Deep hook
- 6 Heavy-duty

F Finish

- 07 Steel, zinc plated
- 52 Stainless steel, passivated

TL - 20 - B 0 L - F

B Base type

- 1 Exposed
- 2 Concealed

TL-40 Draw Latch

Over-center - Wire bail

Features

- Multiple link options for application variances
- Secondary locking style available

Material

- Stainless steel or steel, zinc plated

Product Performance

- Working load:
 - Steel: 220 N
 - Stainless steel: 220 N

Notes

- Install assembly with M4 round head screws (not supplied) or 4 rivets
- Order keepers separately



Exposed Mounting Holes

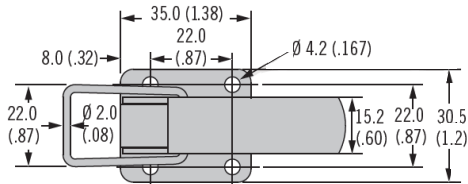

Concealed Mounting Holes

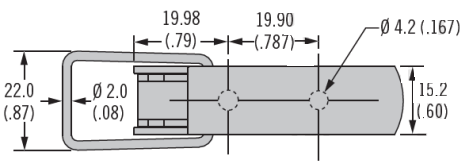

Flat Wire Link

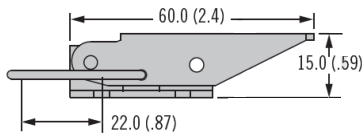

Flat Wire Link

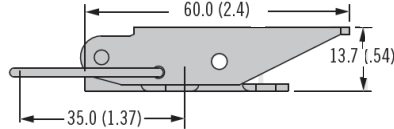

Curved Wire Link

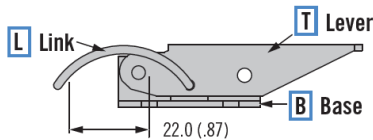

Curved Wire Link

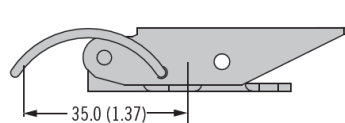

Shallow Hook Link

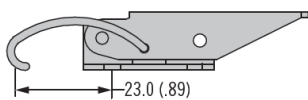

Shallow Hook Link

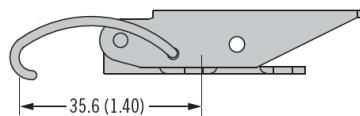

Deep Hook Link

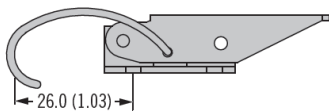

Deep Hook Link

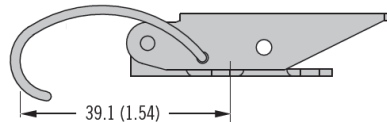

L Link style

- 1 Flat
- 3 Short curved
- 4 Shallow hook
- 5 Deep hook

F Finish

- 07 Steel, zinc plated
- 52 Stainless steel, passivated

B Base type

- 1 Exposed
- 2 Concealed

T Lever type

- 0 Standard
- 1 Secondary catch (Exposed base only)
- 2 Padlockable (Steel model only) (Concealed base only)

TL - 40 - B T L - F

TL-17 Keeper

Keeper

Features

- Multiple keeper options for application variances
- Suitable for all TL-20 and TL-40 latches

Exposed

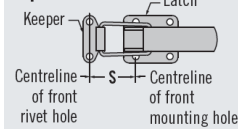

Concealed

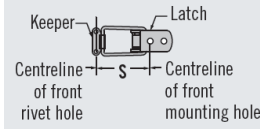

Material

- Stainless steel, steel, zinc plated

Installation Notes

- Install assembly with M4 round head screws (not supplied) or 4 rivets



Small

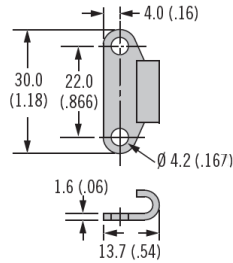

Narrow

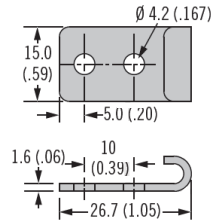

Right Angle

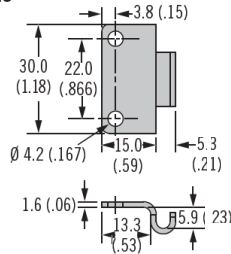

Large

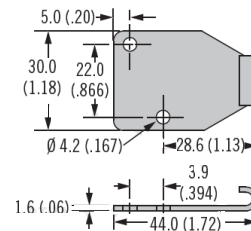

Medium

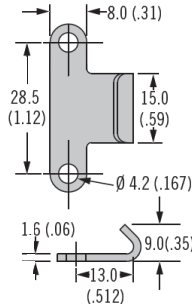

B Base type

- 1 Small
- 2 Narrow
- 3 Right angle
- 5 Large
- 9 Medium

F Finish

- 07 Steel, zinc plated
- 52 Stainless steel passivated

TL - 17 - 20 **B** - **F**

Keeper Style	Small	Narrow	Large	Medium
	TL-17-201-F	TL-17-202-F	TL-17-205-F	TL-17-209-F
Draw Latch	S Dimension			
TL-20-101	44.7 (1.76)	46.7 (1.84)	62.0 (2.44)	49.0 (1.93)
TL-20-102	30.3 (1.19)	32.3 (1.27)	47.6 (1.87)	34.6 (1.36)
TL-20-103	44.7 (1.76)	46.7 (1.84)	62.0 (2.44)	49.0 (1.93)
TL-20-106	33.9 (1.33)	35.9 (1.41)	51.2 (2.02)	38.2 (1.50)
TL-20-201	41.7 (1.64)	43.7 (1.72)	59.0 (2.32)	46.0 (1.81)
TL-20-202	28.2 (1.11)	30.2 (1.19)	45.5 (1.79)	32.5 (1.28)
TL-20-203	41.7 (1.64)	43.7 (1.72)	59.0 (2.32)	46.0 (1.81)
TL-40-101	30.7 (1.21)	32.7 (1.29)	48.0 (1.89)	35.0 (1.38)
TL-40-103	30.7 (1.21)	32.7 (1.29)	48.0 (1.89)	35.0 (1.38)
TL-40-201	43.7 (1.72)	45.7 (1.80)	61.0 (2.40)	48.0 (1.89)
TL-40-203	43.7 (1.72)	45.7 (1.80)	61.0 (2.40)	48.0 (1.89)

TL-50 Draw Latch

Over-center · Wire bail

Features

- Robust construction
- Padlockable

Material

- Stainless steel or steel, zinc plated

Product Performance

- Working load: 2,490 N
- Install assembly with M5 round head screws (not supplied) or 5 rivets

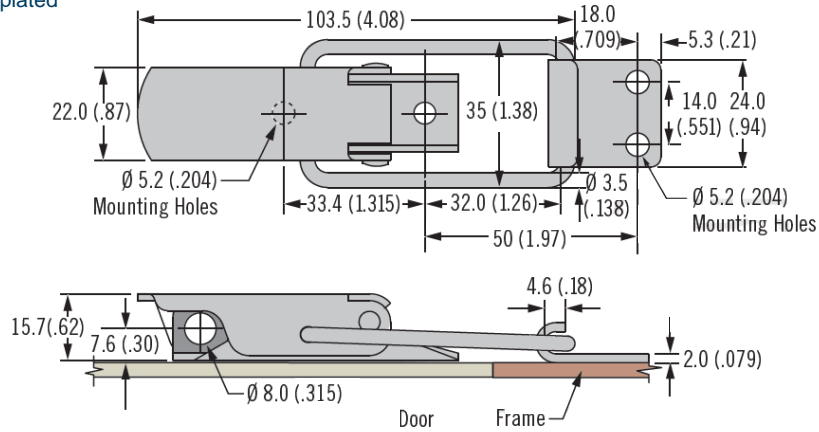

Description	Part Number	
	Steel	Stainless Steel
Latch	TL-50-201-07	TL-50-201-52
Keeper	TL-17-501-07	TL-17-501-52

TL-60 Draw Latch

Over-center · Wire bail

Features

- Robust construction
- Padlockable

Material

- Steel, zinc plated

Product Performance

- Working load: 2,670 N
- Install assembly with M5 round head screws (not supplied) or 5 rivets

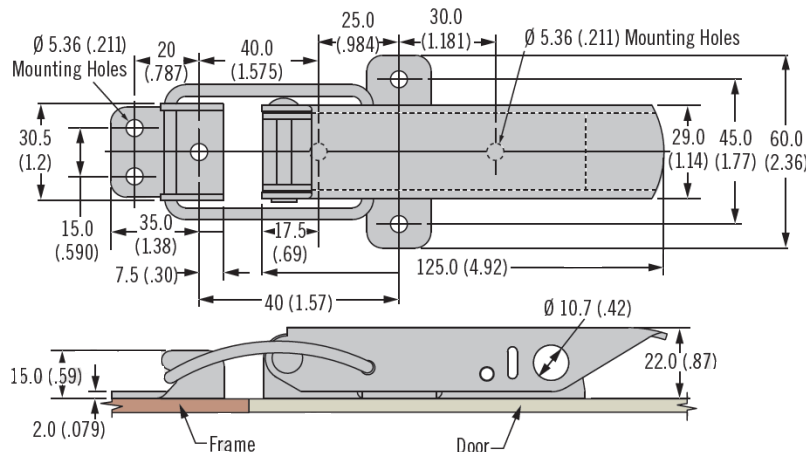

Description	Part Number
Draw Latch	TL-60-102-07
Keeper	TL-17-601-07